

# TRANSFER OF JURISDICTION

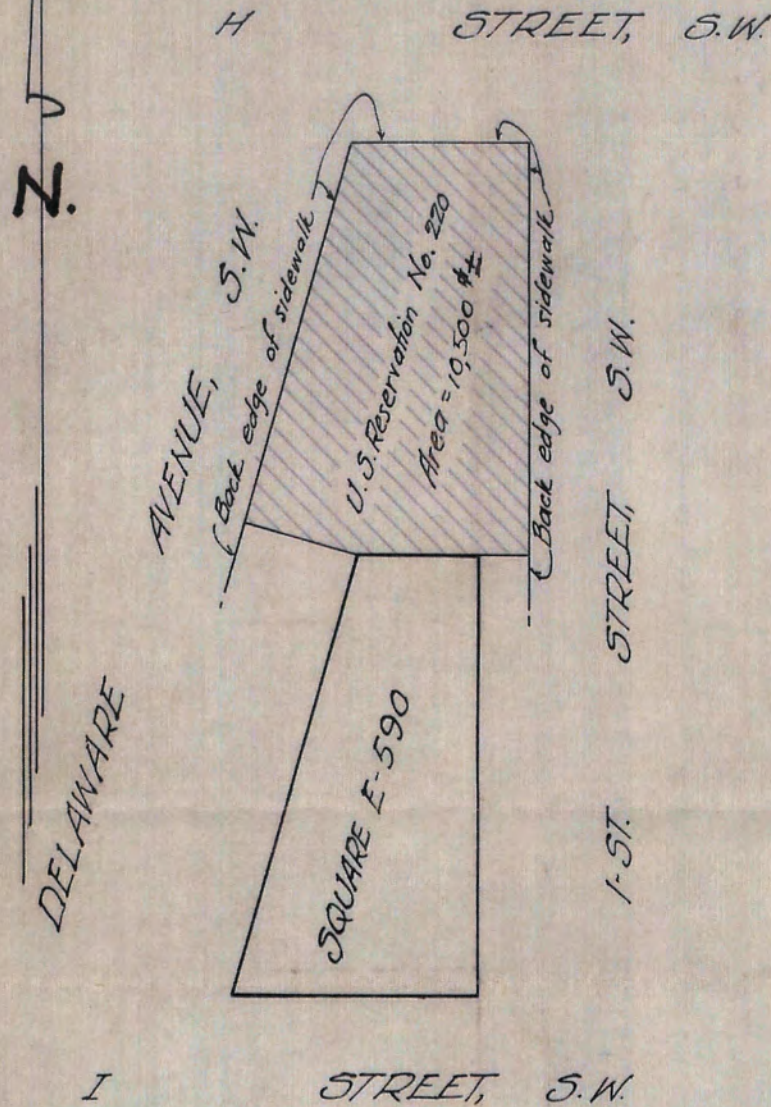

Department of the Interior  
National Park Service

Washington, D.C. 2/8 1957.

In accordance with Public Act No. 143, approved May 20, 1932, I hereby transfer to the jurisdiction of the Commissioners of the District of Columbia the area shown hereon in hatched lines for highway purposes.

Conrad L. Witt  
Director of National Park Service.

Office of the Commissioners of the District of Columbia  
Washington, D.C. February 19, 1957.

In accordance with Public Act No. 143, approved May 20, 1932, the transfer offered hereon in hatched lines is hereby accepted.

By order of the Board of Commissioners of the District of Columbia.

Harold Bartholomew  
Secretary to the Board

National Capital Planning Commission

Washington, D.C. Feb. 3, 1956.

In accordance with Public Act No. 143, approved May 20, 1932, and Public Act No. 592, approved July 19, 1952.

Recommended by vote of Commission.

Harold Bartholomew  
Chairman

Office of the Surveyor of the District of Columbia

Washington, D.C. FEB. 20 1957.

I certify that the foregoing plat is correct and is approved for record in this office.

J. J. Seal  
Surveyor, D.C.

SURVEYORS OFFICE, DISTRICT OF COLUMBIA  
Made for: Director of Highways, D.C. 12-1-55  
Drawn by: R.C.H. Checked by: MM S.O. 25892  
Computation by: T.S.W. Scale: 1 inch = 50 feet  
Recorded at: 1:00 P.M. February 20, 1957  
Recorded in Book 37 page 178  
Filed City Subs. Under "U.S. Res. 220"

TRANSFER OF JURISDICTION

Department of the Interior National Park Service  
Washington, D.C. February 8, 1957

In accordance with Public Act No. 143, approved May 20, 1932, I hereby transfer to the jurisdiction of the Commissioners of the District of Columbia the area shown hereon in hatched lines for highway purposes.

(signed) Conrad L. Wirth  
Director of National Park Service

Office of the Commissioners of the District of Columbia  
Washington, D.C. February 19, 1957.

In accordance with Public Act No. 143, approved May 20, 1932, the transfer offered hereon in hatched lines is hereby accepted.  
By order of the Board of Commissioners of the District of Columbia.

(signed) G.M. Thornett  
Secretary to the Board

National Capital Planning Commission  
Washington, D.C. February 3, 1956.

In accordance with Public Act No. 143, approved May 20, 1932, and Public Act No. 592, approved July 19, 1952.  
Recommended by vote of Commission.

(signed) Harland Barthblomew  
Chairman

I certify that the foregoing plat agrees with the records of this office and was recorded on February 20, 1957 at 1:00 P.M.

*R.C. Hoyle*  
Surveyor, District of Columbia

Scale: 1 inch - 50 feet

R.L.Q.

178  
CITY SUBS  
RES 220

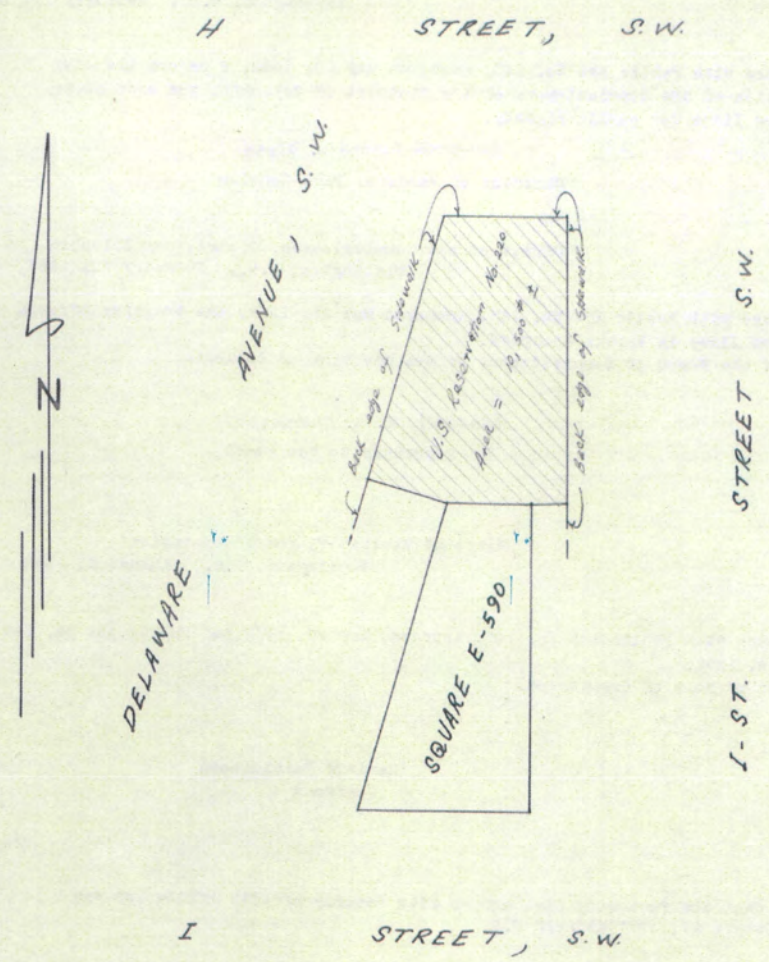

BGM

JGN